

Supply Voltage (Vs): 5 - 30 Vdc Std **Micropower:** 2 - 6 Vdc (for ultra low current draw, ideal for battery applications)
Input Current: 15 mA Std. 0.06 mA
Pulse Out (Vo): 1 - 10 Vpp Std.
Input Sensitivity: 30 mV, 12 mV, 5 mV 12 - 40 mV
Temp. Ranges: **Standard:** -40° to 160° F (-40° to 80° C), **In Line & Ultra Compact:** -40° to 240° F (-40° to 120° C)
Frequency Range: To 10 kHz, up to 40 kHz varies with signal level, target size, air gap & sensor. **Micro** 1 Hz-30 kHz

4021 Pulse Amplifier

Multi Output, Noise Canceling
Standard and/or Opto-isolated
Fits GUAL-16 type Explosion-proof enclosure

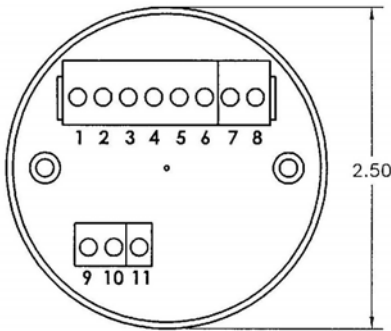

4022 Pulse Amplifier

With Optional Output Select
Fits Elby Explosion-proof enclosure

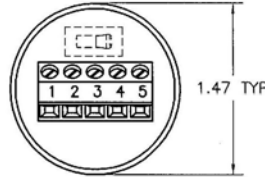

4023 Pulse Amplifier

Fits Y1 Explosion-proof enclosure

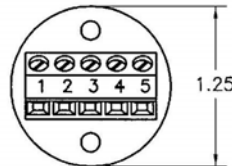

4024 in-Line Pulse Amplifier

With MS Connector

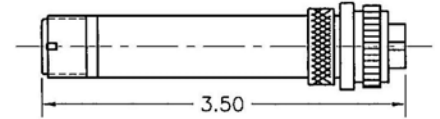

4024M

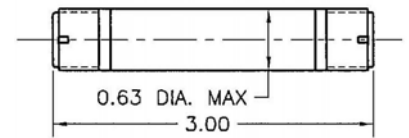

4024H Ultra Compact

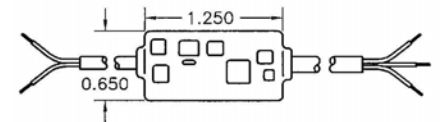

4026 FTC - FTV Converter

FTC Converter: 4-20mA, 10-50mA
FTV Converter: 0-5 Vpp, 0-10 Vpp
Fits Y3 Explosion-proof enclosure

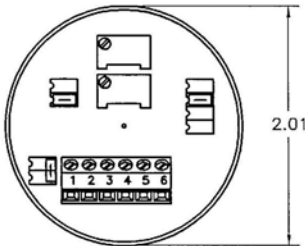

4027 Freq to Current Converter

4-20 mA Converter fits
Elby Explosion-proof enclosure

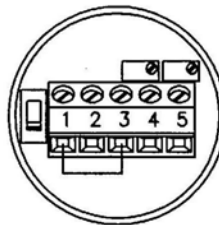

4028 Freq to Voltage Converter

0-5 V or 0-10 V FTV Converter fits
Elby Explosion-proof enclosure

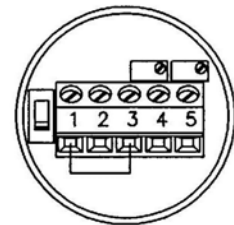

4029 Digital Opto-Isolated Current Loop

Fits Elby Explosion-proof enclosures

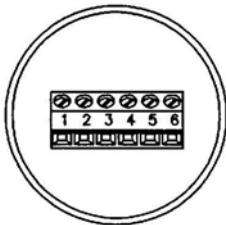

4033 Directional Mag Preamp

Provides directional data from two
magnetic speed pickups
Fits Y3 Explosion-proof enclosure

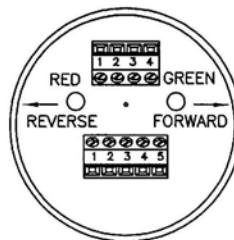

4051 Speed Flow Switch, SS1

For Magnetic Speed sensors,
Open collector output
Fits Elby Explosion-proof enclosure

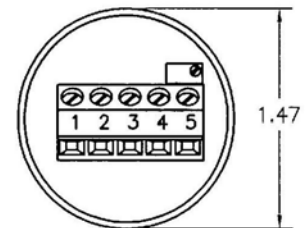

Detailed specification sheets are available for each sensor listed; please contact Spectec for more information.